

► Advantages:

- IP68 Waterproof.
- Simple connection mode.
- No disassembly ,quickly check internal moisture and humidity.



► Features:

Body size	L140 x W140 x H84mm
IP Grade	IP68
Housing material	Stainless steel 316L
Cover	Tempered glass & 316L Panel
Optional hole position	9PCS(Max.)

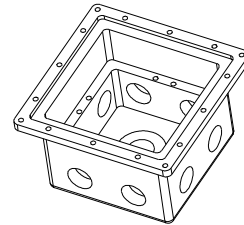
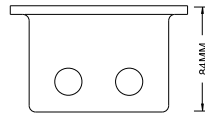
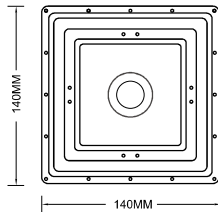

► Installations:

No.1 Installation of waterproof joint

Wrapping 15 circles around the drain joint with waterproof tape, then twist the waterproof joint to the outlet hole of the waterproof box. Repeat with a wrench until tightened.



Picture 1

No.2 Wire stripping

Peeling outer jacket with 150mm, and peel the wire core with 4mm, then the cable is ready.

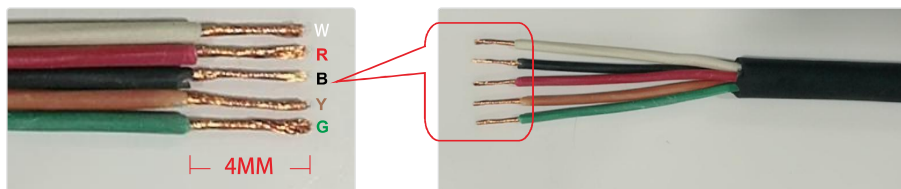

Detail

Picture 2

No. 3 Installation of cable

Inserting the cable from every waterproof joint into the waterproof box and tighten them with the wrench.

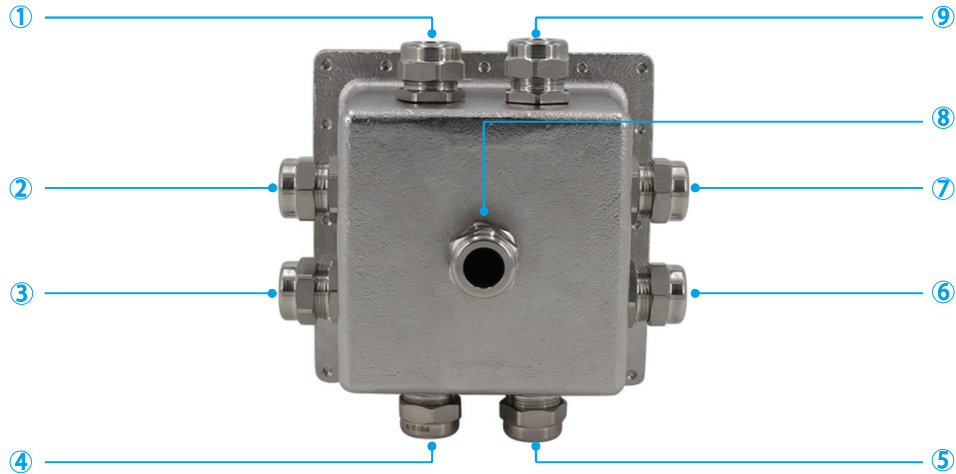

No.4 Connect terminal and lock circuit board

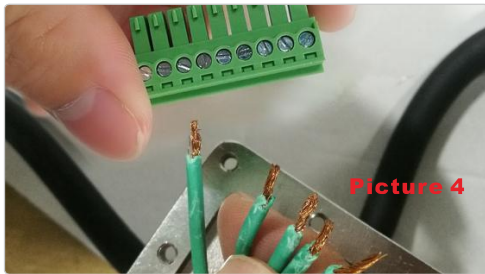

Loosen the screw on the terminals and insert the same color core into the same set of terminals.

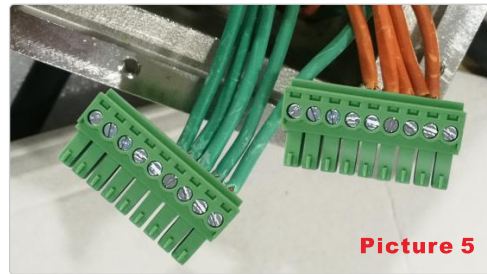

Lock the cores on the terminals.

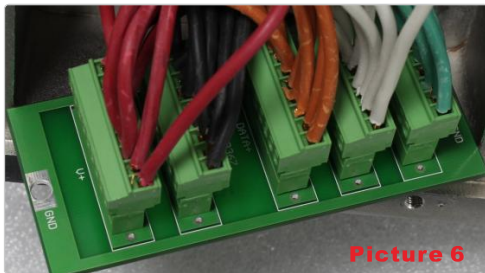

Insert the terminals into the corresponding terminal seat on the PCB.
(Make Sure the ground line on the right place)

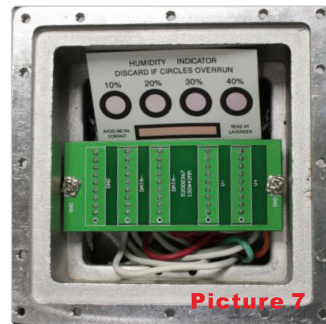

Fix the PCB on the junction box by screws.

No. 5 Put the moisture test paper into Junction box and lock the top cover

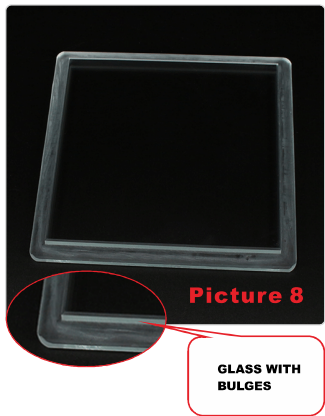

The glass with bulges is upward to face the cover of junction box.

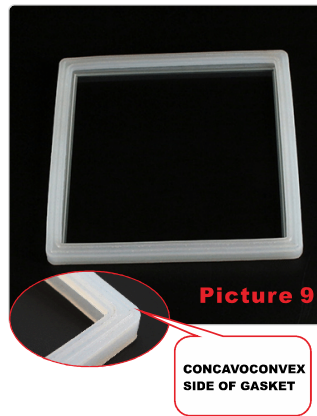

Concavoconvex side of gasket is downward to bottom of junction box

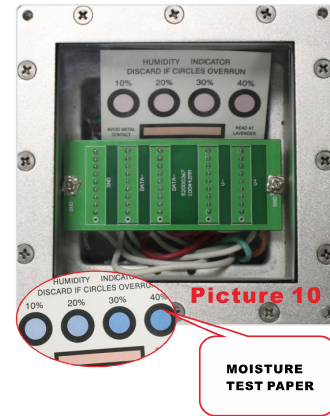

Open the moisture test paper and put it on the PCB. Cover the glass lock the Stainless Steel cover!

No. 6 Lock the protective cover



Check the SS cover for deformation, lock it and tighten the screws.